

Key to Part Number Coding

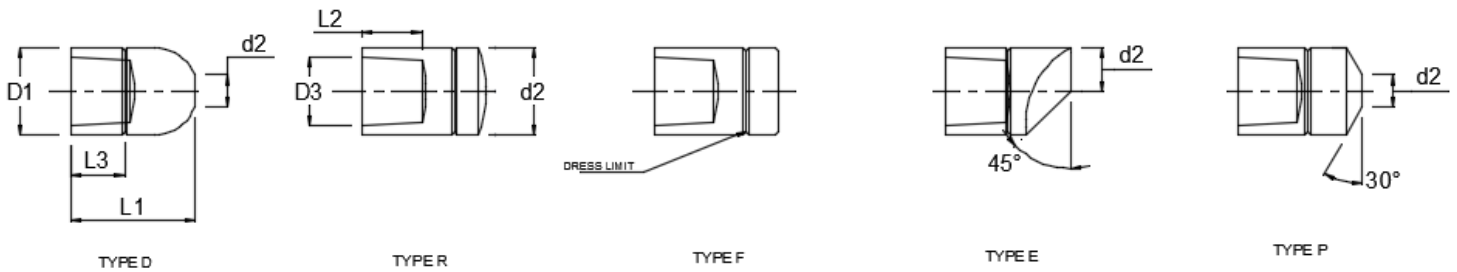
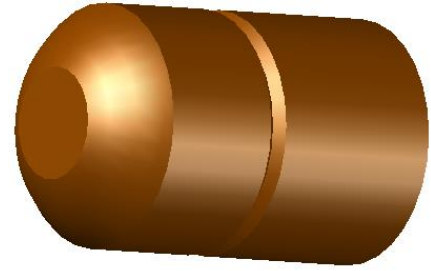
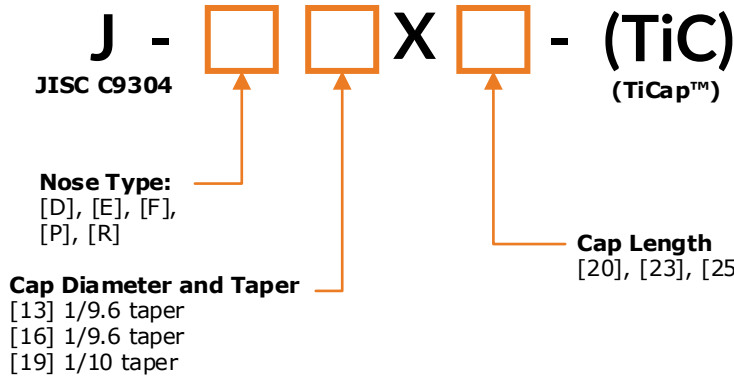

Note: Default material for these caps is class 2 (C18150)

Cap Size	Type	Overall Diameter [D1]	Overall Length [L1]	Taper Diameter [D3]	Taper Length [L2]
13	D, E, F, P, R	13mm	20mm	10mm	10mm
16	D, E, F, P, R	16mm	23mm	12.6mm	11mm
19	D, E, F, P, R	19mm	25mm	14mm	15mm

Cap	Weld Face Diameter [d2]	Dress Line [L3]
J-D13X20	6mm	10mm
J-D16X23	6mm	10mm
J-D19X25	8mm	11.5mm
J-E13X20	5mm	10mm
J-E16X23	8mm	11.5mm
J-F13X20	----	----
J-F16X23	----	17mm
J-F19X25	----	17mm
J-P13X20	4mm	----
J-P16X23	6mm	13mm
J-R13X20	15mm sphere rad	----
J-R16X23	20mm sphere rad	17mm
J-R19X25	20mm sphere rad	19mm

Examples:

J-P16X23-TiC:

1/9.6 taper, P nose, 16mm diameter, 23mm length, 6mm weld face, TiC coated

J-F19X25:

1/10 taper, F nose, 19mm diameter, 25mm length

J-R13X20:

1/9.6 taper, R nose, 13mm diameter, 20mm length, 15mm sphere radius